



## How to Enroll to the European Studies Certificates (Undergraduate and Graduate)

**Step 1: Download and install the Suitable App**

**Step 2: Once installed, log in to suitable using your pitt e-mail (you may be required to verify your account, please follow the instructions)**

Enter your school email address

Continue

**Use your Pitt account password to login.**



**Username**

**Password**

Show Password

Login

[Switch Accounts](#) [Forgot Password?](#)

**Step 3: Click on categories (see image below)**

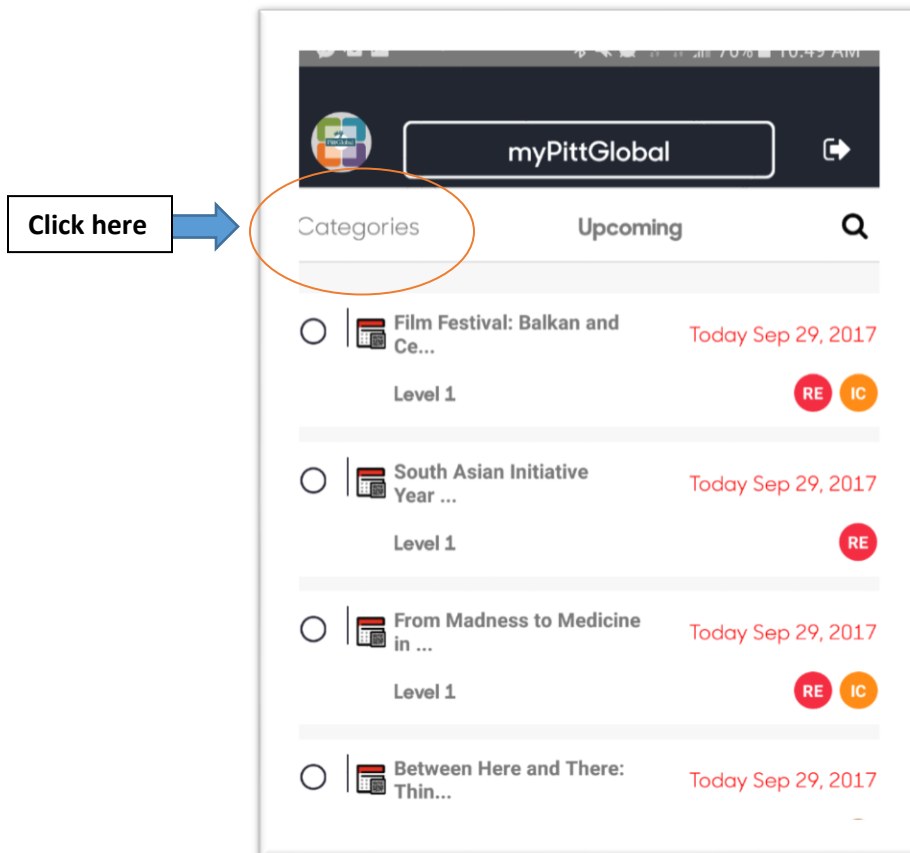

**Step 4: Choose all (See image below)**

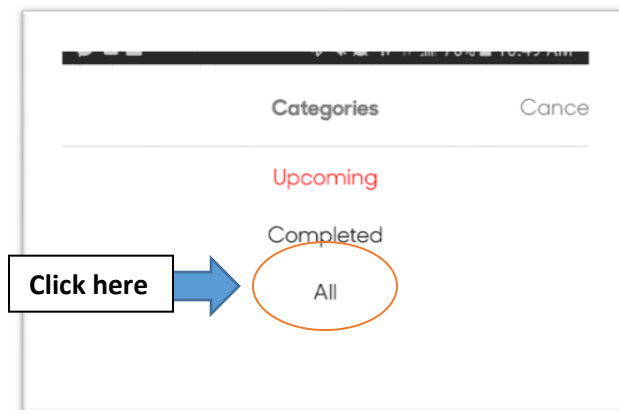

### Step 5: Click the Search button

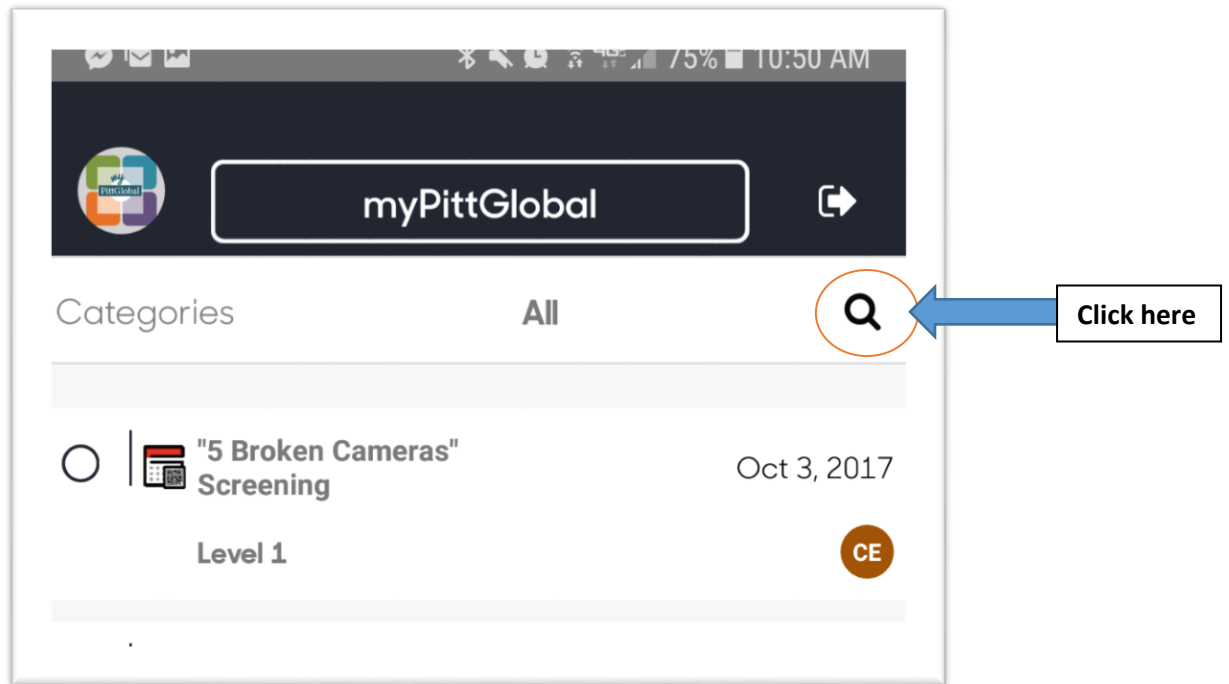

### Step 6: Enter the enrollment Search (Undergraduate and Graduate)

#### Undergraduate

- For the European Union Studies Undergraduate Certificate enter **(euscug) Undergraduate Enrollment** (below)

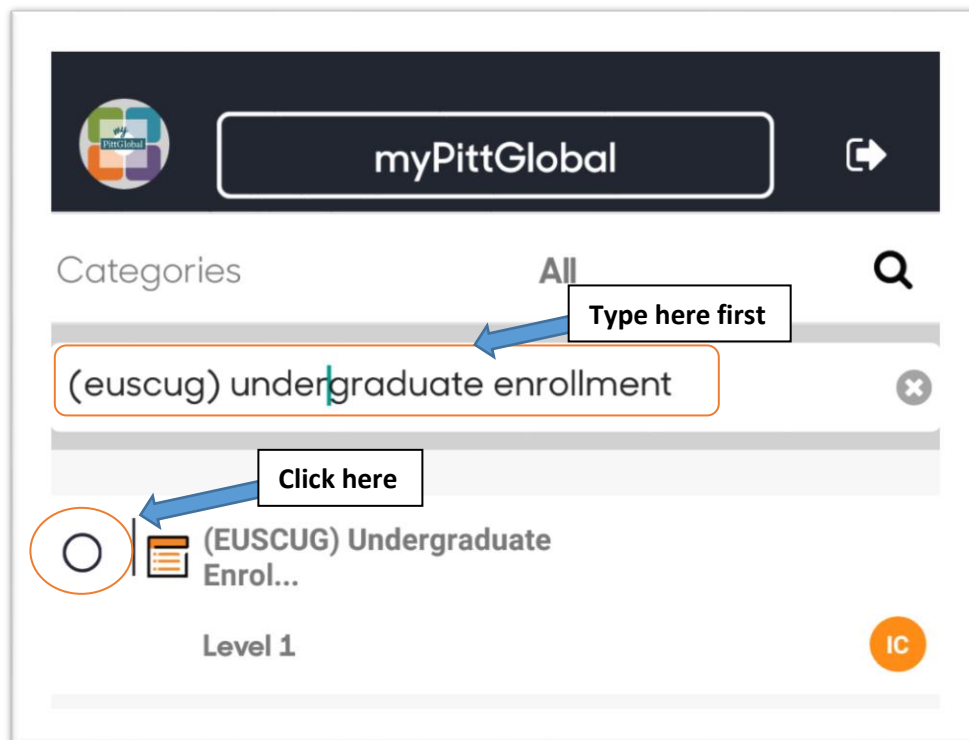

- For the West European Studies Undergraduate Certificate enter **(wescug) Undergraduate Enrollment** (below)

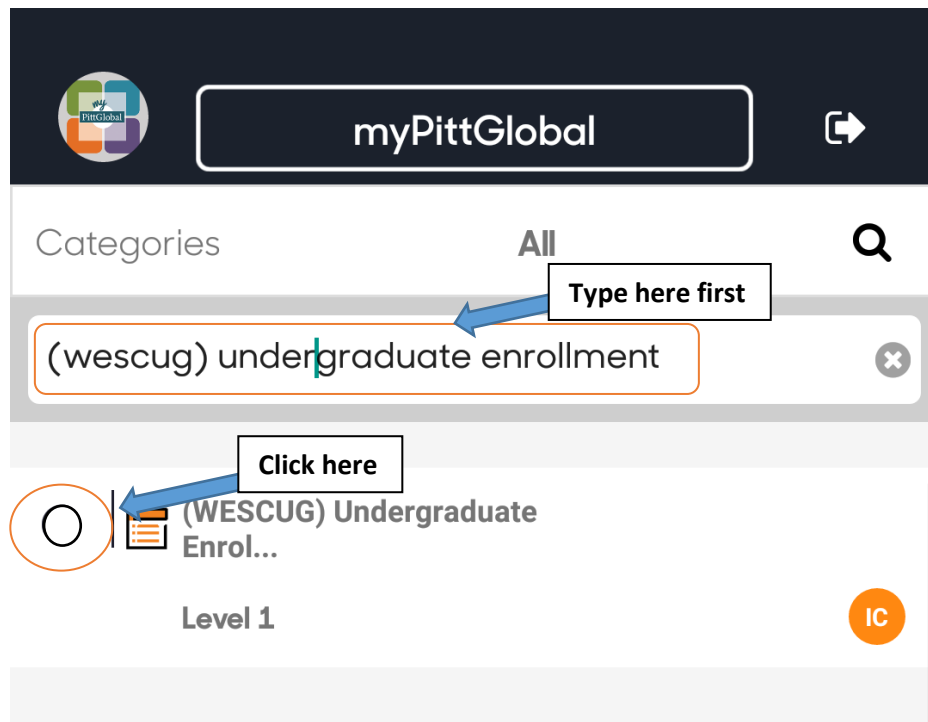

- For the Transatlantic Studies Undergraduate Certificate enter **(tscug) Undergraduate Enrollment** (below)

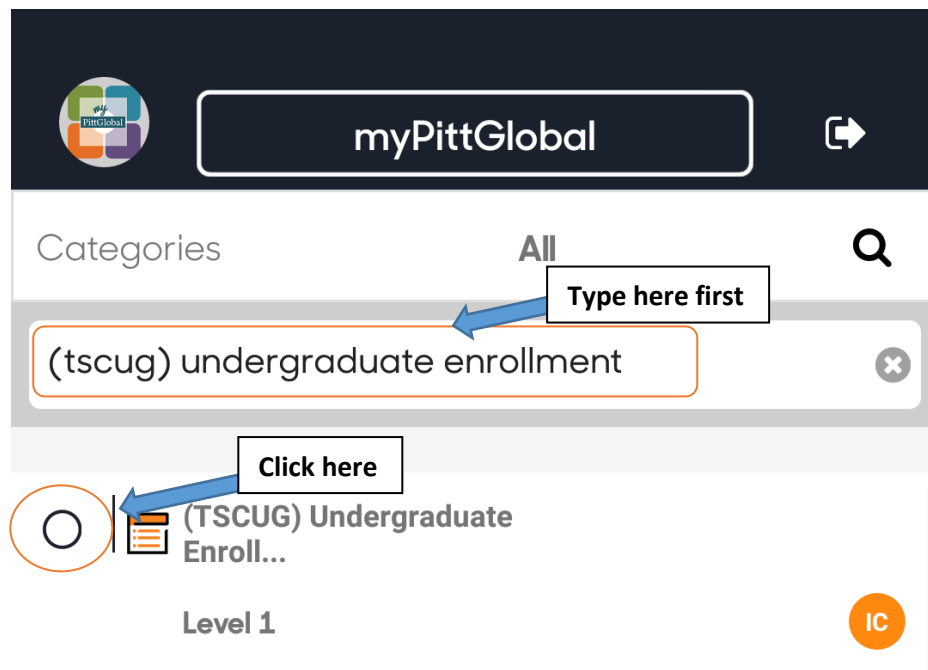

- For the Related Concentration in European and Eurasian Studies Undergraduate Certificate enter **(eesrc) Undergraduate Enrollment** (below)

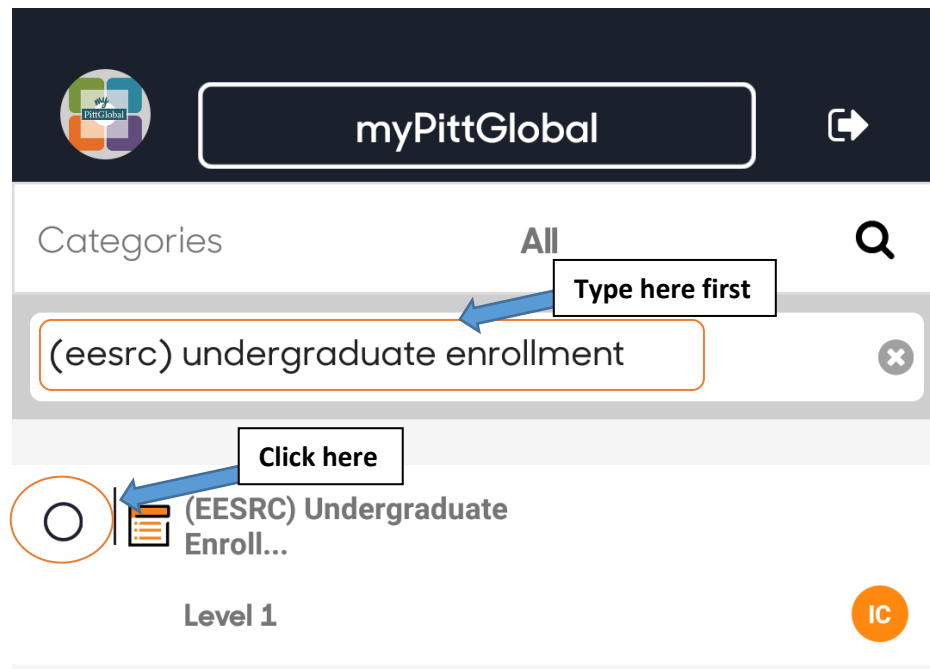

## Graduate

- For the European Union Graduate Certificate enter **(euadv) graduate enrollment**

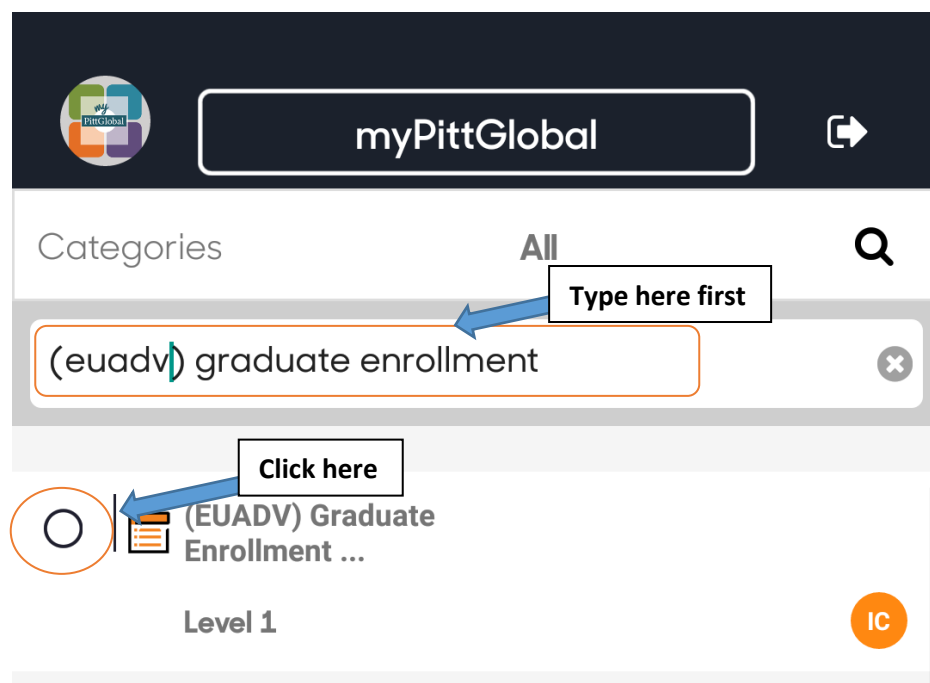

- For the Asian Studies GSPIA No Language Graduate Track enter **(gspianl) graduate enrollment**

